

REAMENAGEMENT DES ESPACES PUBLICS DU CENTRE-VILLE DE TOULOUSE

Saint Sernin 171023



BAU
Prof. Joan Busquets
Michel Desvigne paysagiste
Egis Bâtiments
LEA





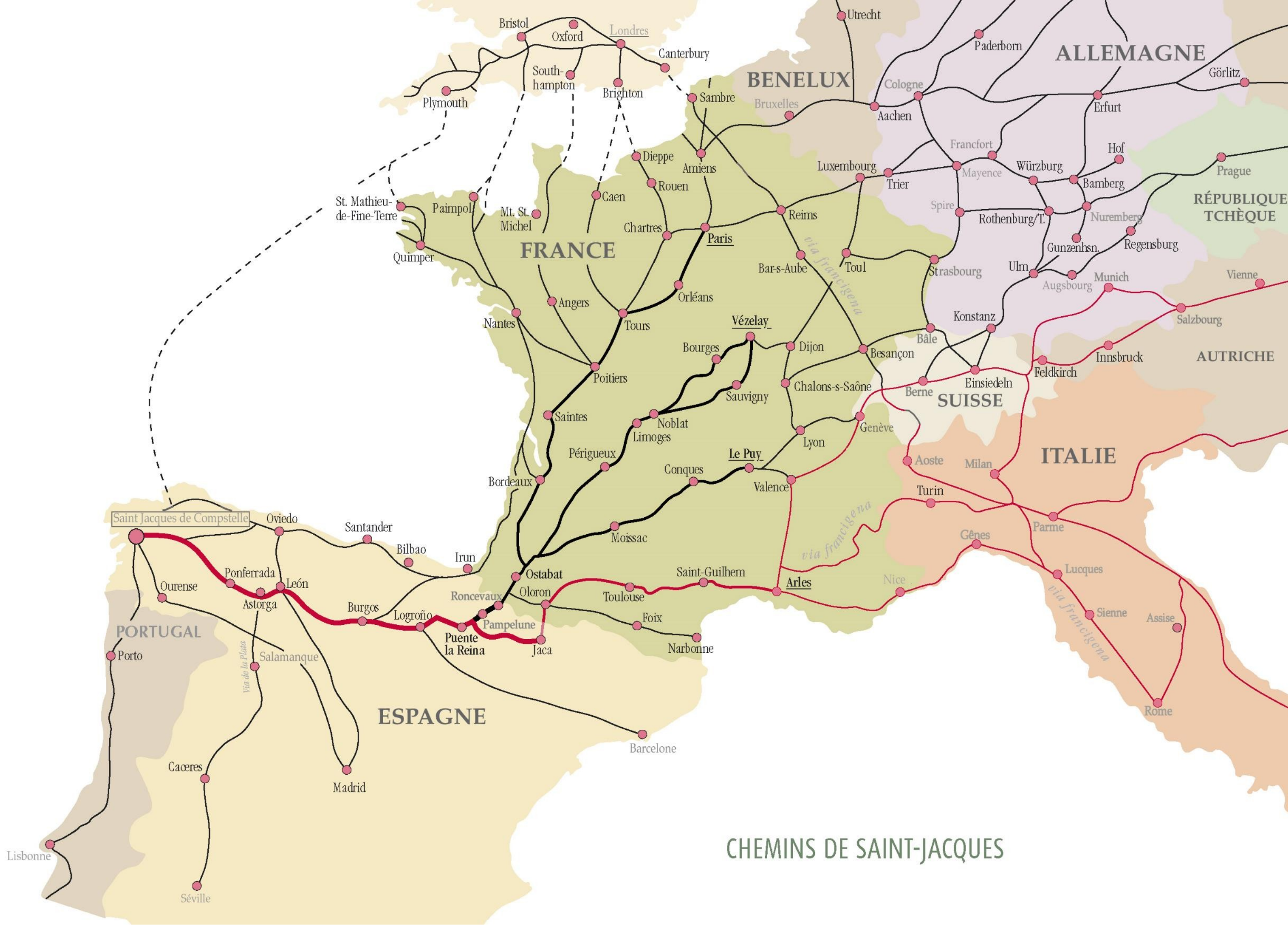

CHEMINS DE SAINT-JACQUES

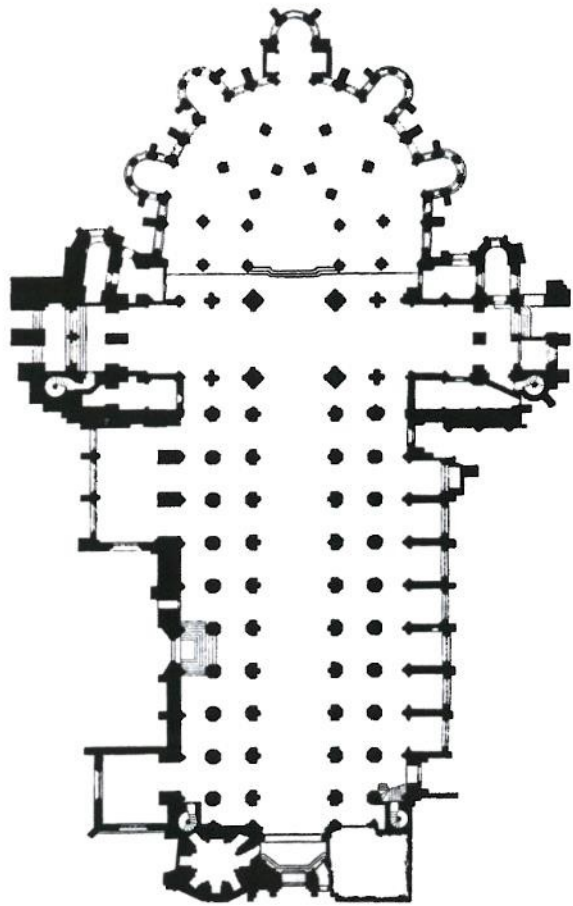

SAINT-MARTIN DE TOURS

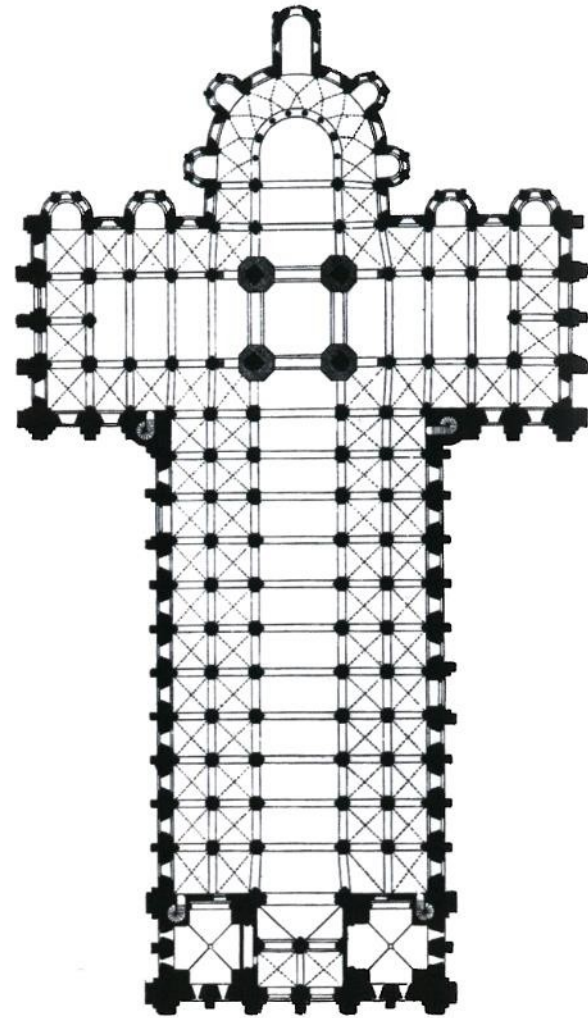

SAINT-SERNIN DE TOULOUSE

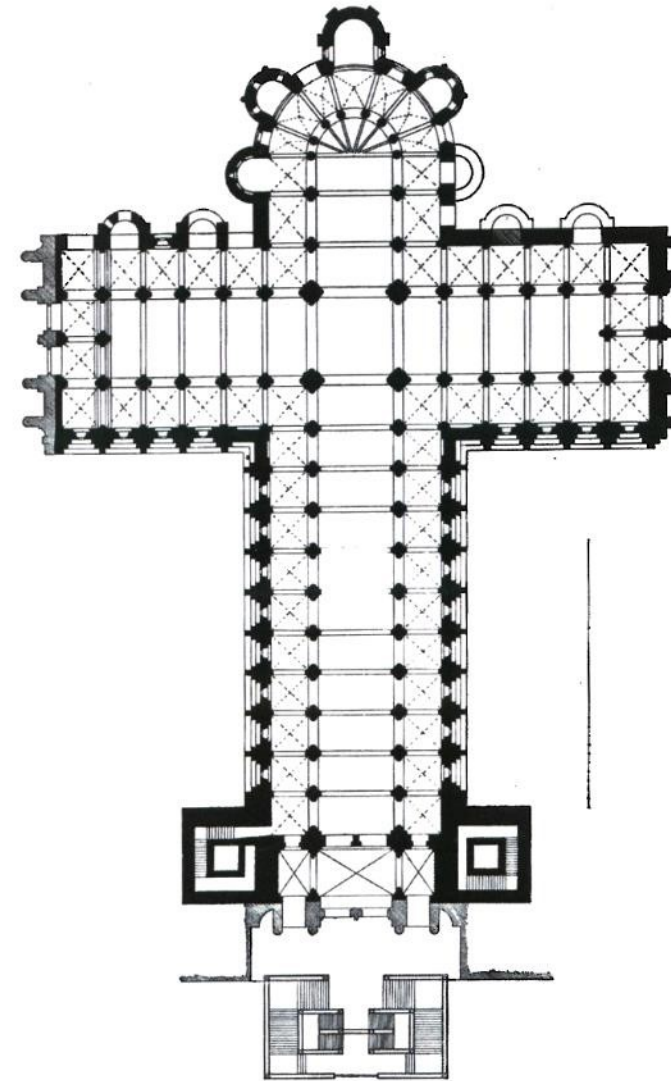

SAINT-JACQUES DE
COMPOSTELLE

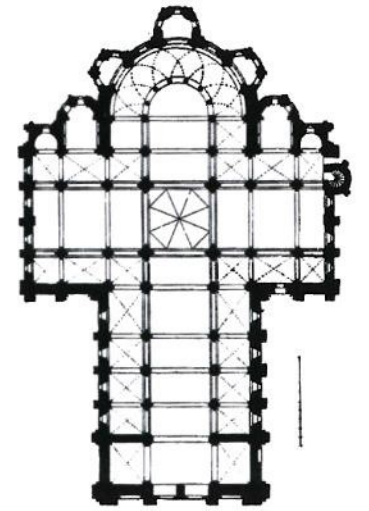

SAINTE-FOY DE CONQUES



Enceintes

0 100 N
DIN A3 E: 1/10.000

- Rempart romaine ■■■■
- Rempart du bourg Saint Sernin ■■■■
- Rempart du faubourg Saint Cyprien ■■■■
- ensemble abbatial Sain Sernin ———
- paroisses XII ème s ■■■■

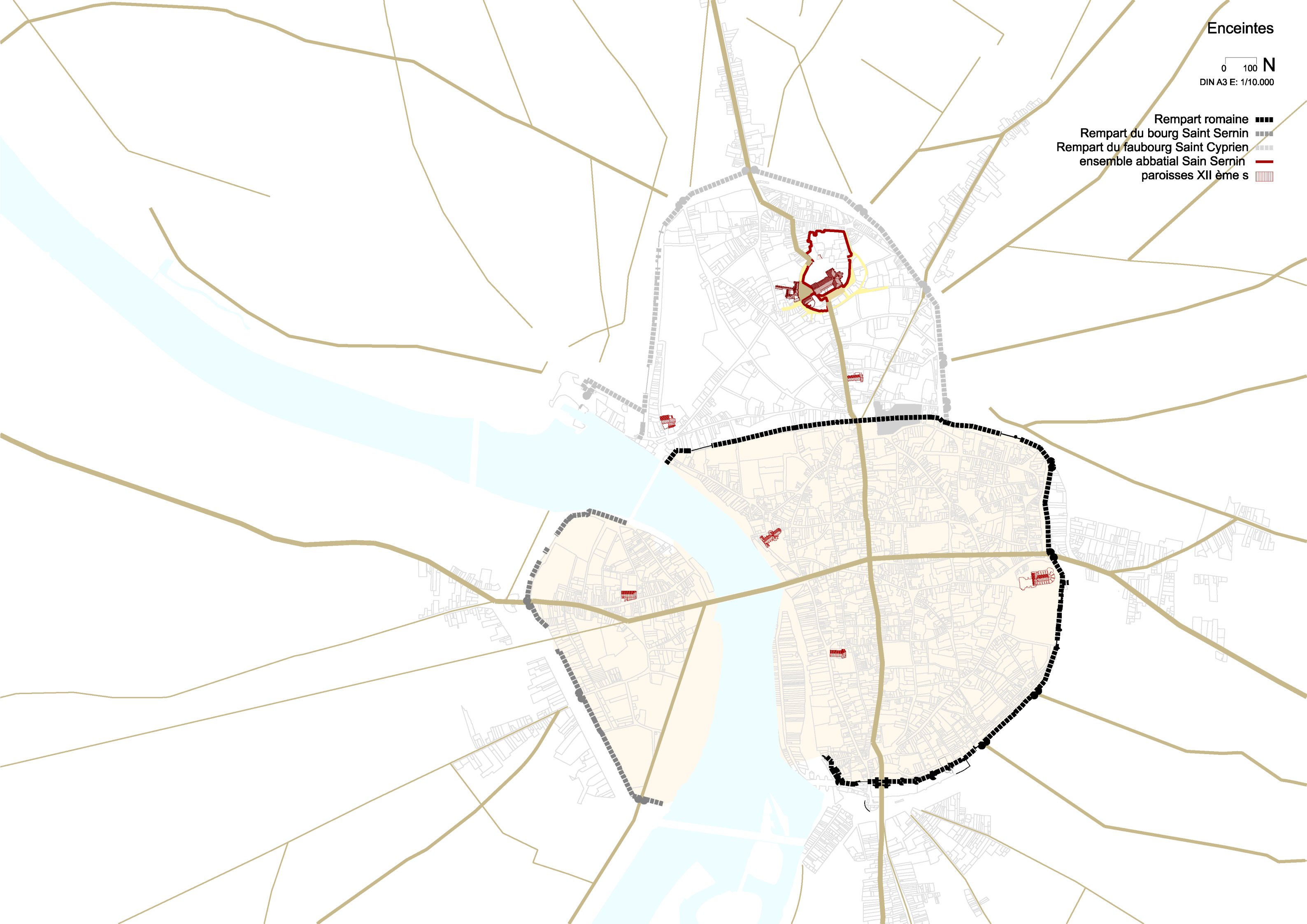

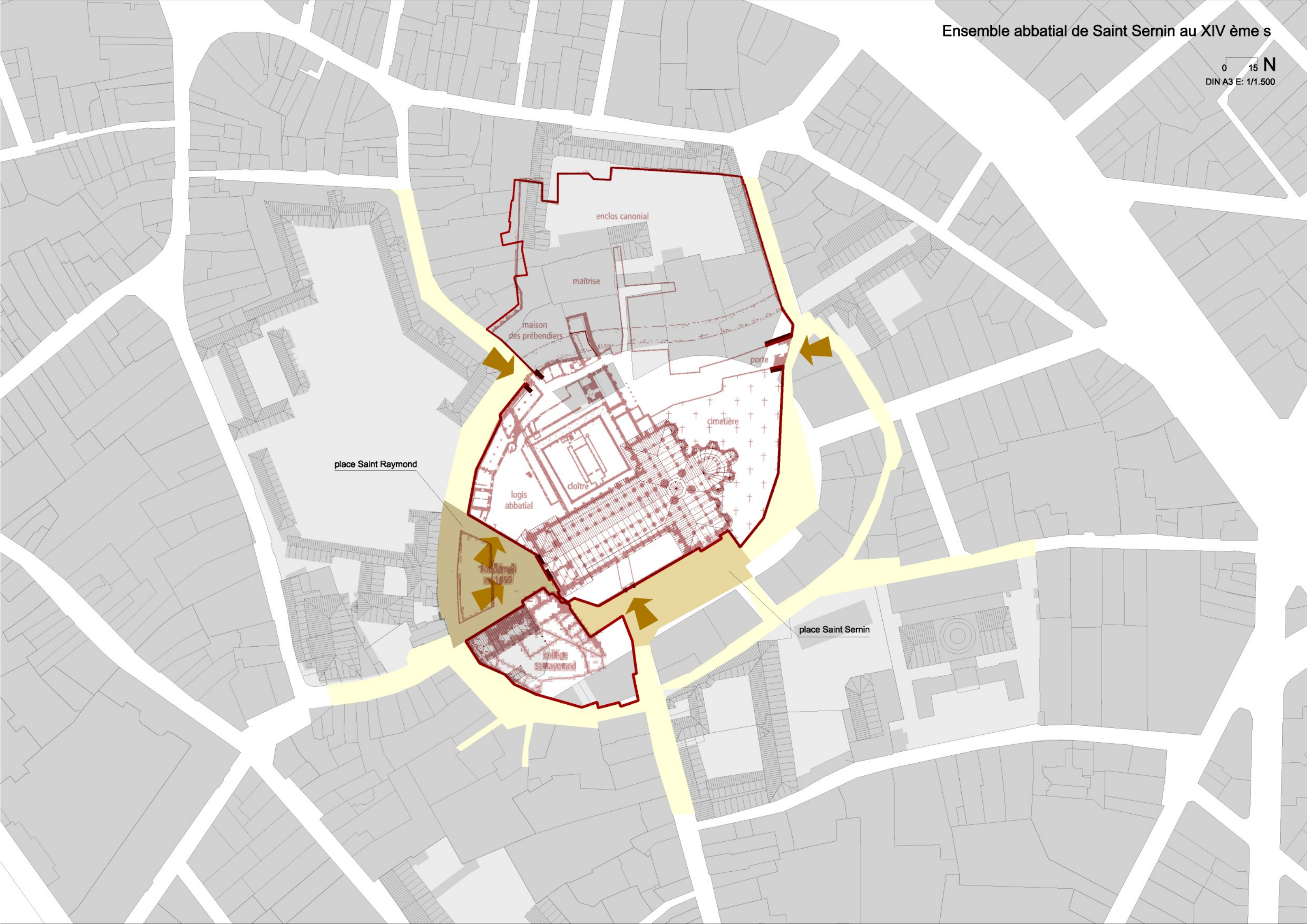



Avant l'intervention de Viollet-le-Duc

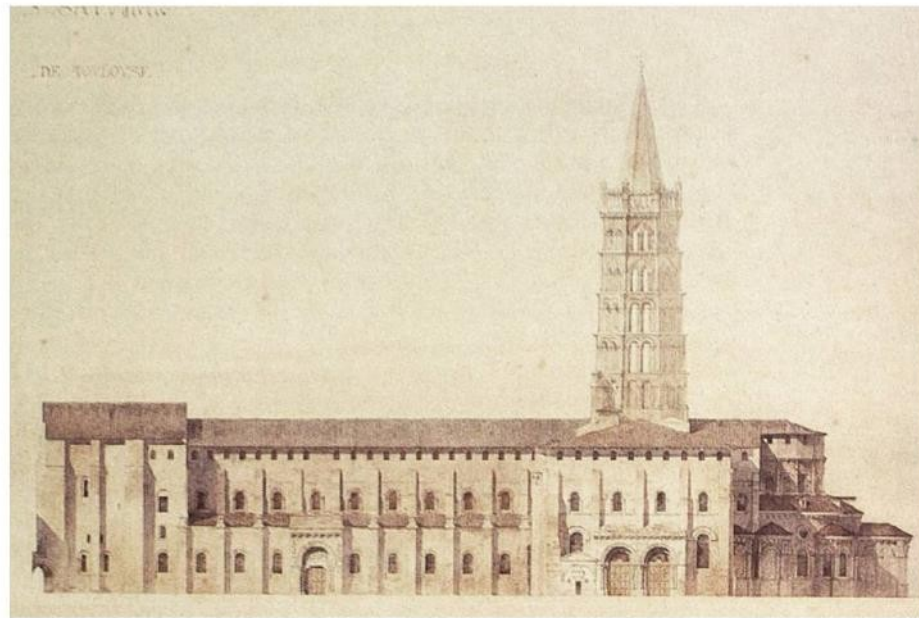

Avant l'intervention de Viollet-le-Duc



Après l'intervention de Viollet-le-Duc



Projet de Viollet-le-Duc

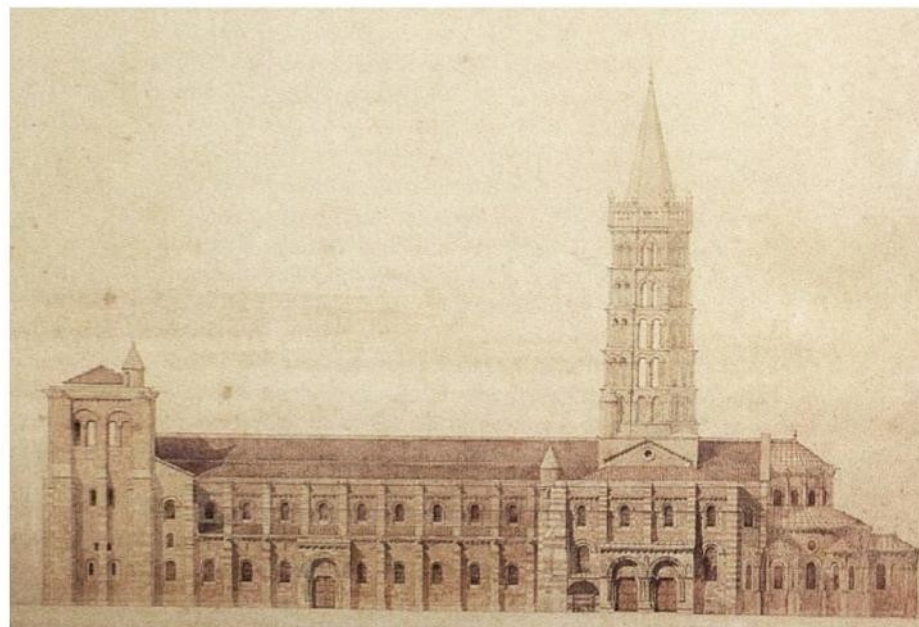

Projet de Viollet-le-Duc



Après la « dérestauration »

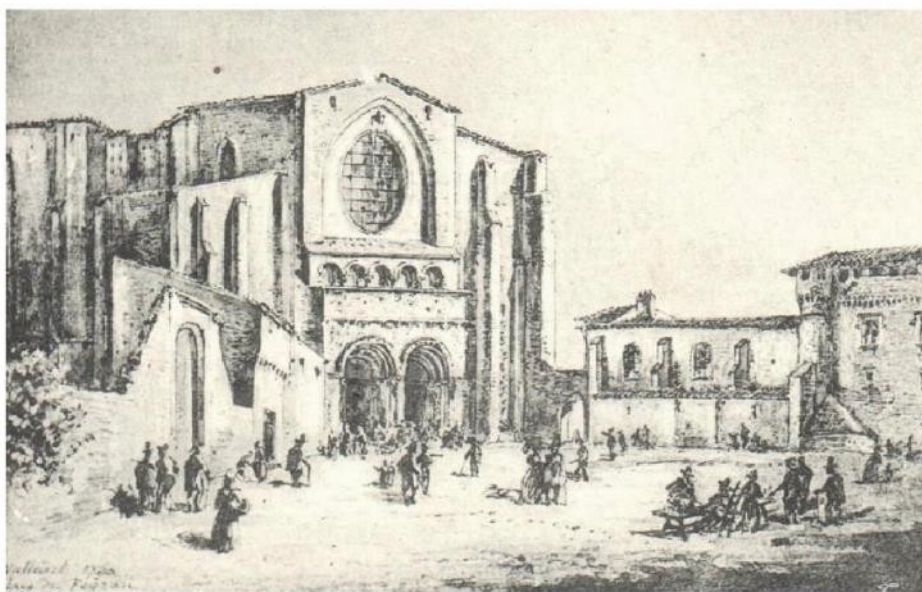

1760



Après l'intervention de Viollet-le-Duc



Après la « dérestauration ». Le massif occidental est régularisé en 1929

Superposition des alignements

0 15 N
DIN A3 E: 1/1.500

- Virebent 1827
- Vitry 1841
- Viollet 1846
- Viollet 1866

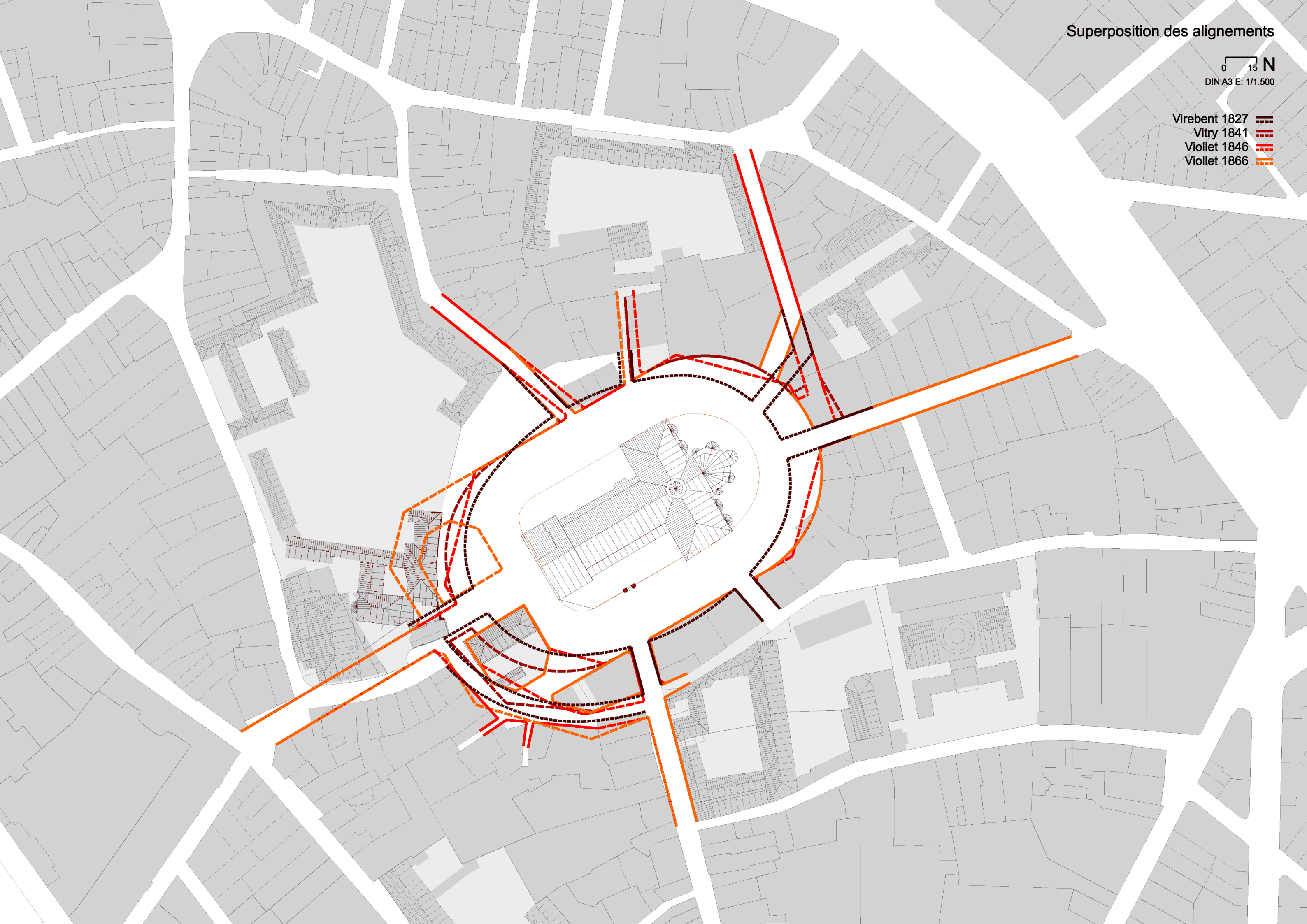

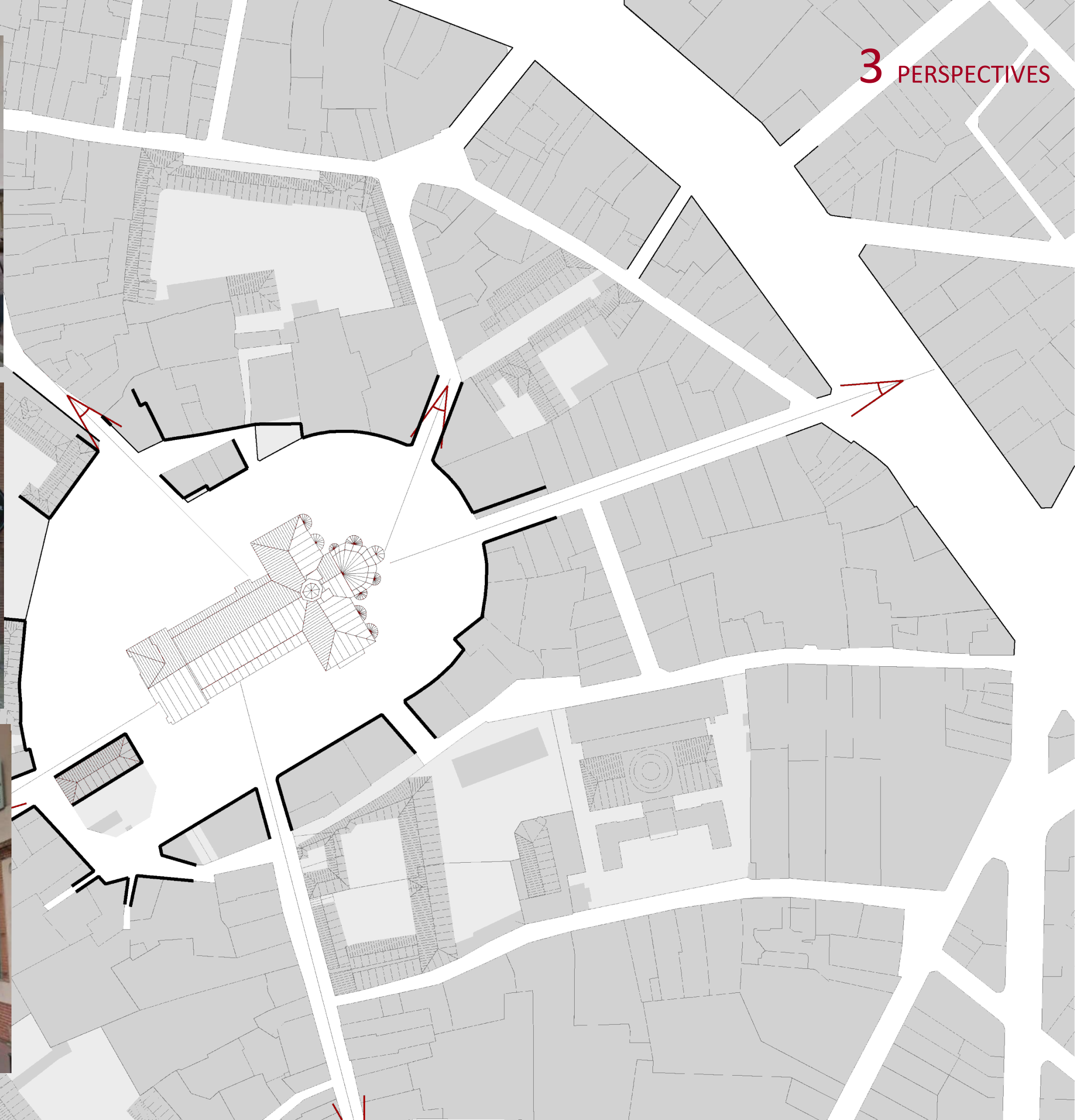

Enceintes



Plans d'alignements

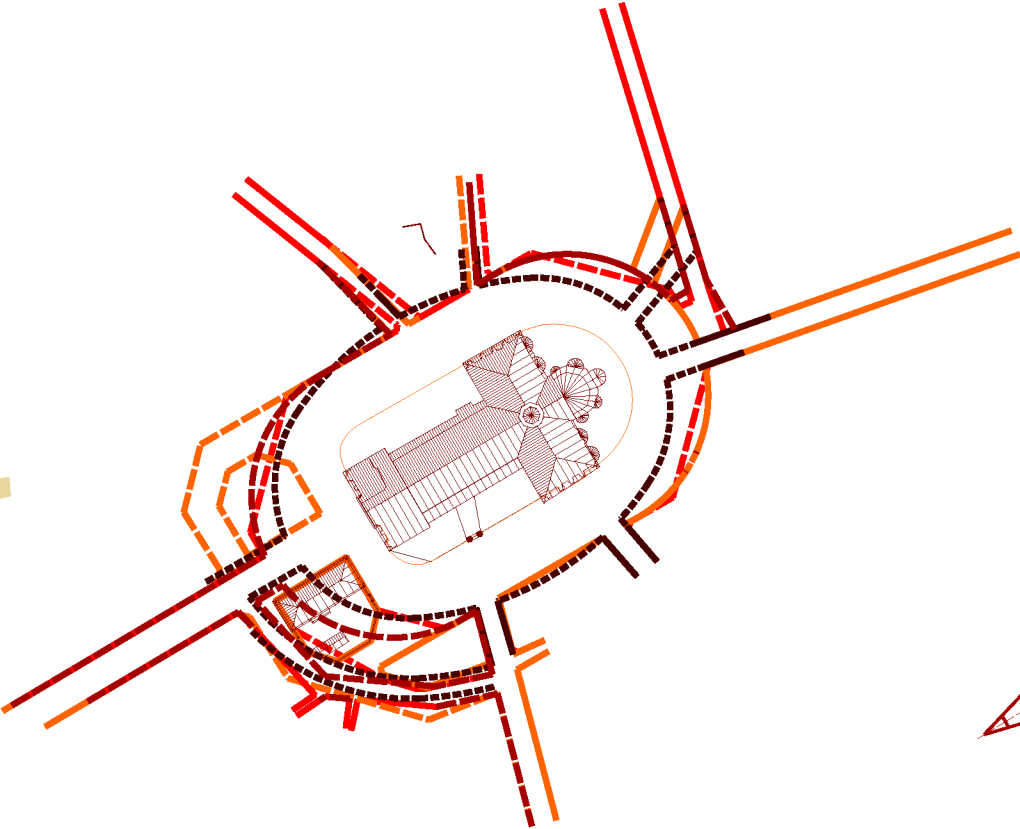

Visuelles

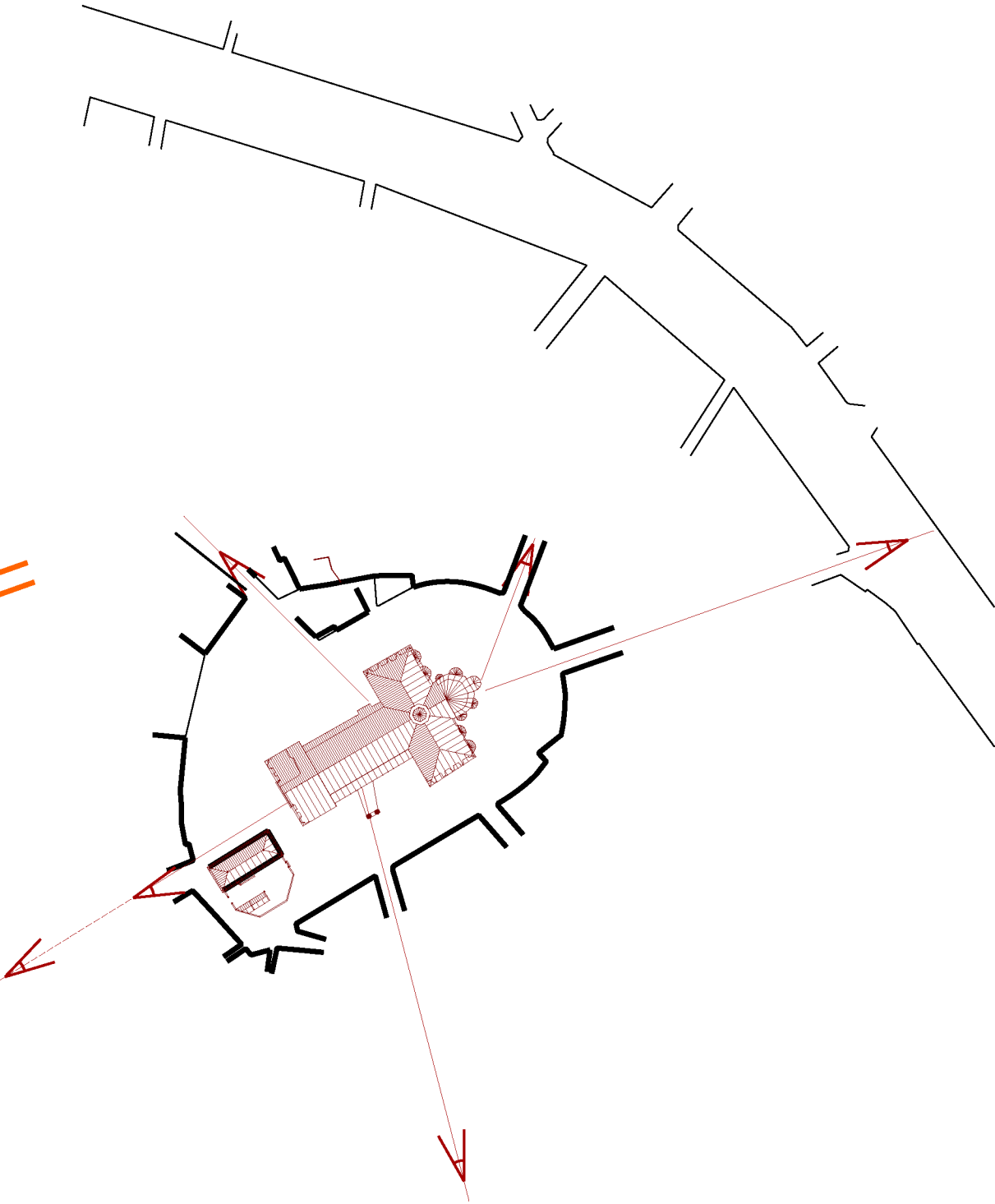



169 places de stationnement
dont 6 PMR

Espaces végétalisés = 2155m² (12% du site)

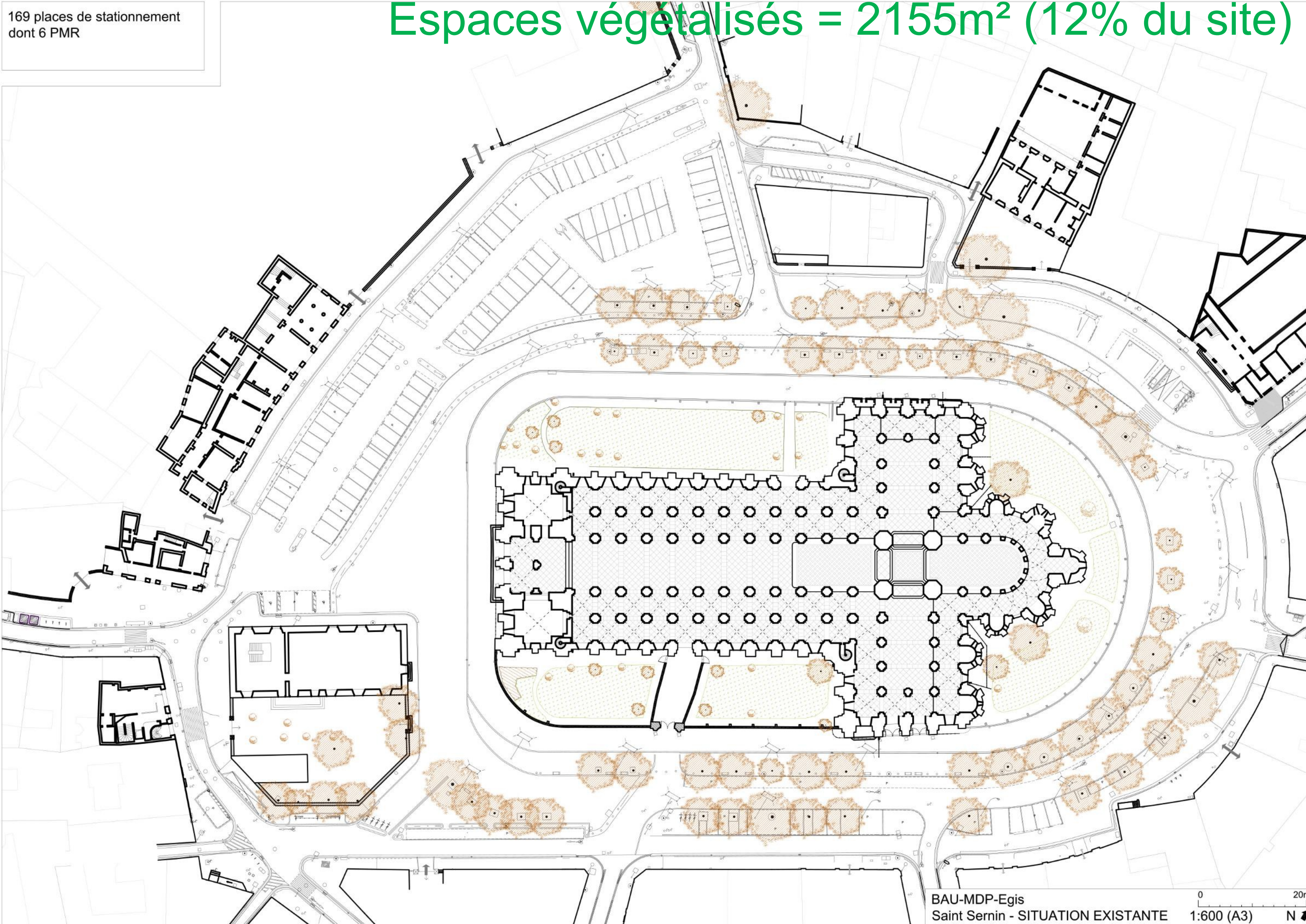

Espaces végétalisés = 4934m² (27% du site)

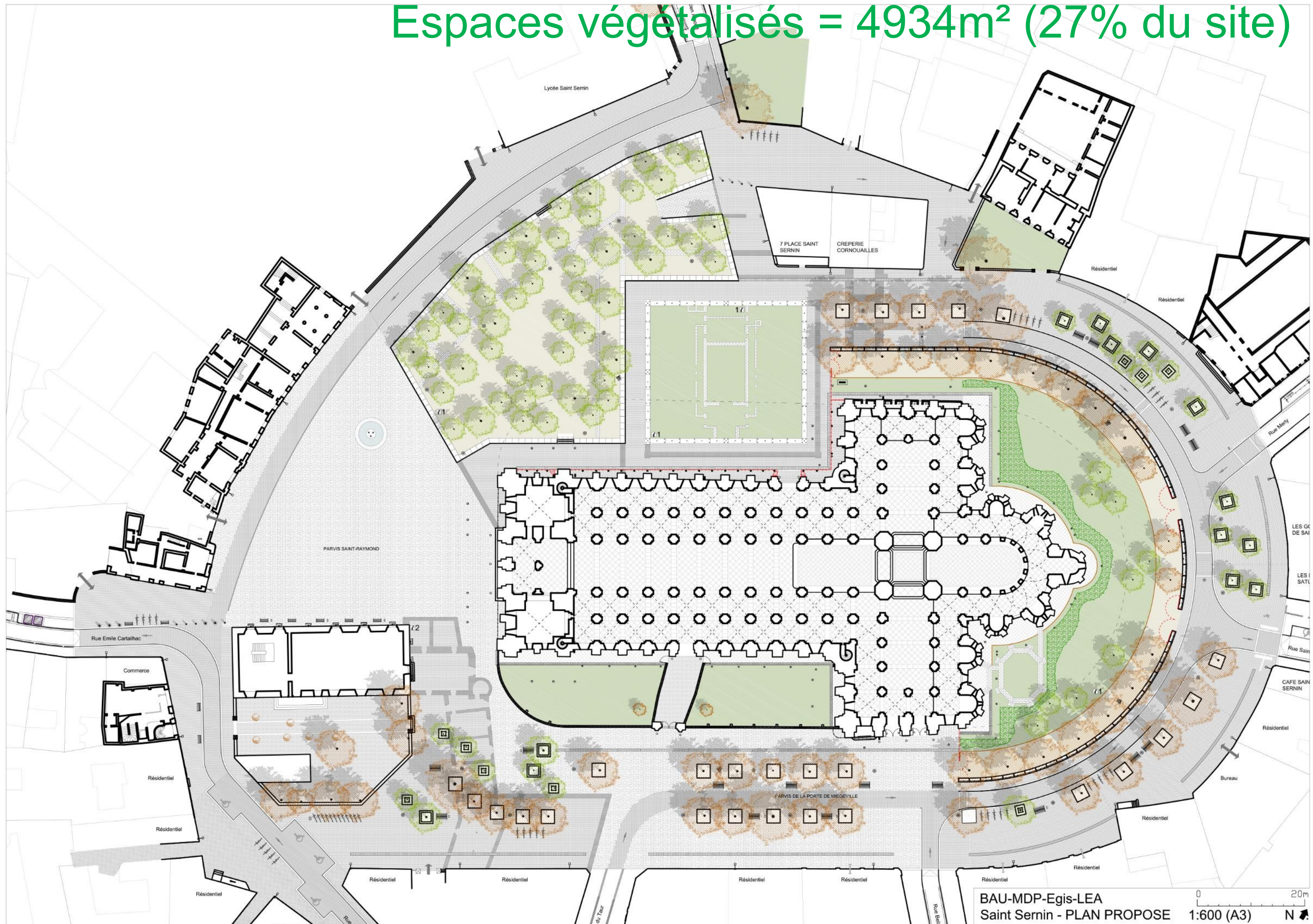

Ensemble abbatial de Saint Sernin au XIV^{ème} s

0 15 N
DIN A3 E: 1/1.500



Place Saint Raymond





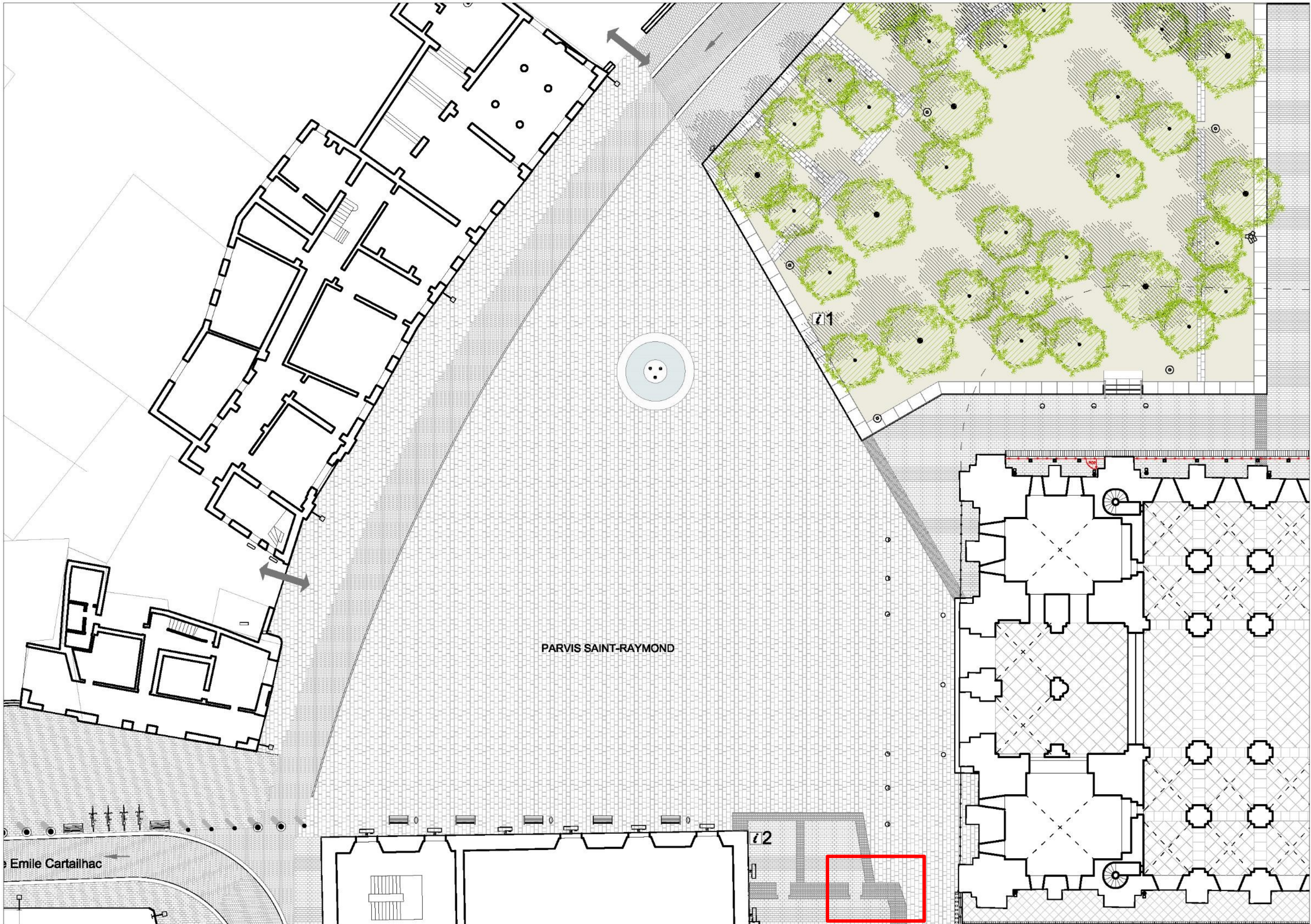

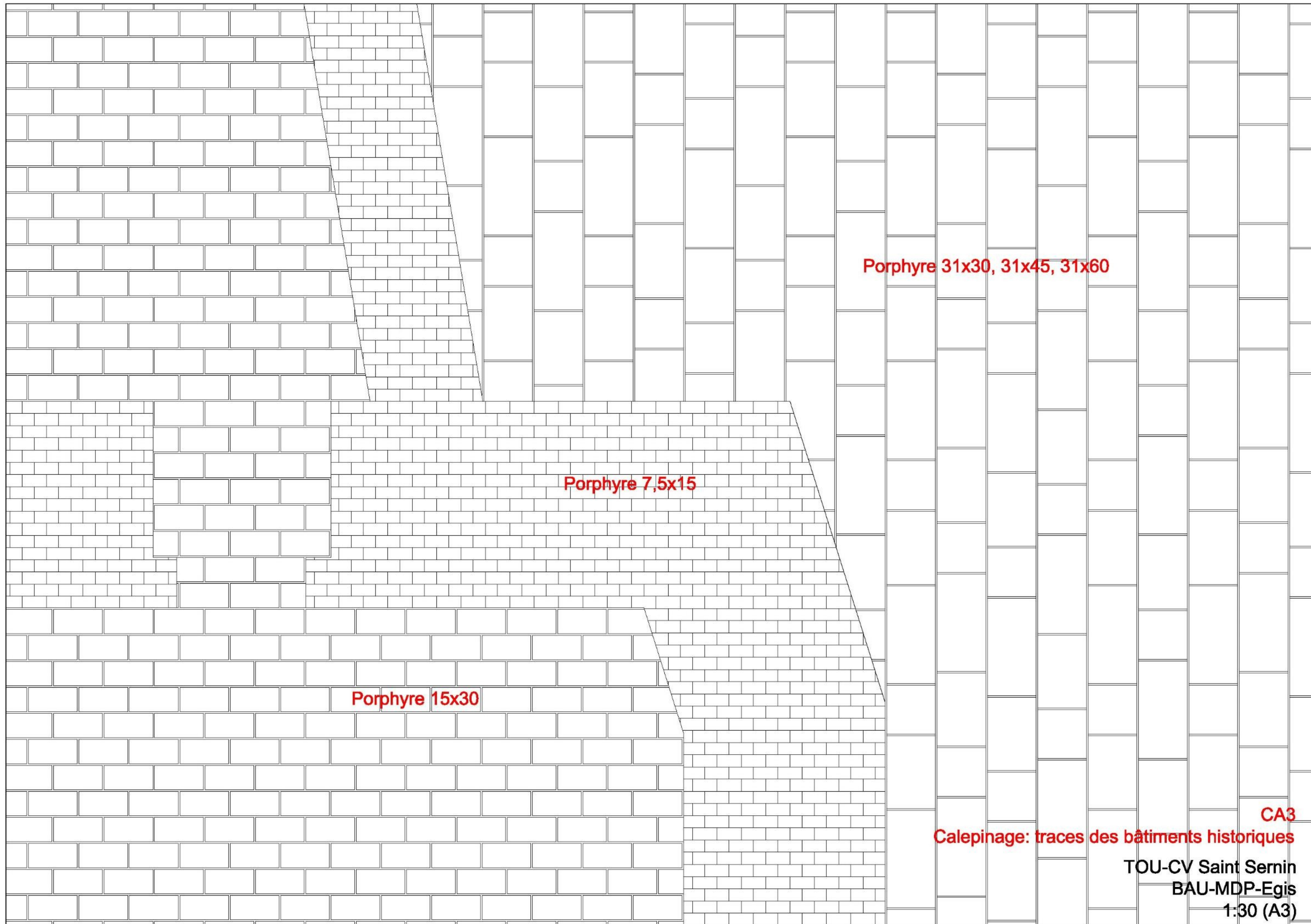

Porphyre 31x30, 31x45, 31x60

Porphyre 7,5x15

Porphyre 15x30

CA3

Calepinage: traces des bâtiments historiques

TOU-CV Saint Sernin

BAU-MDP-Egis

1:30 (A3)

Planche d'essai



Planche témoin C
Voir explications sur le tripode
toulouse
métropole



toulouse
métropole
Toulouse en grand !







Chevet

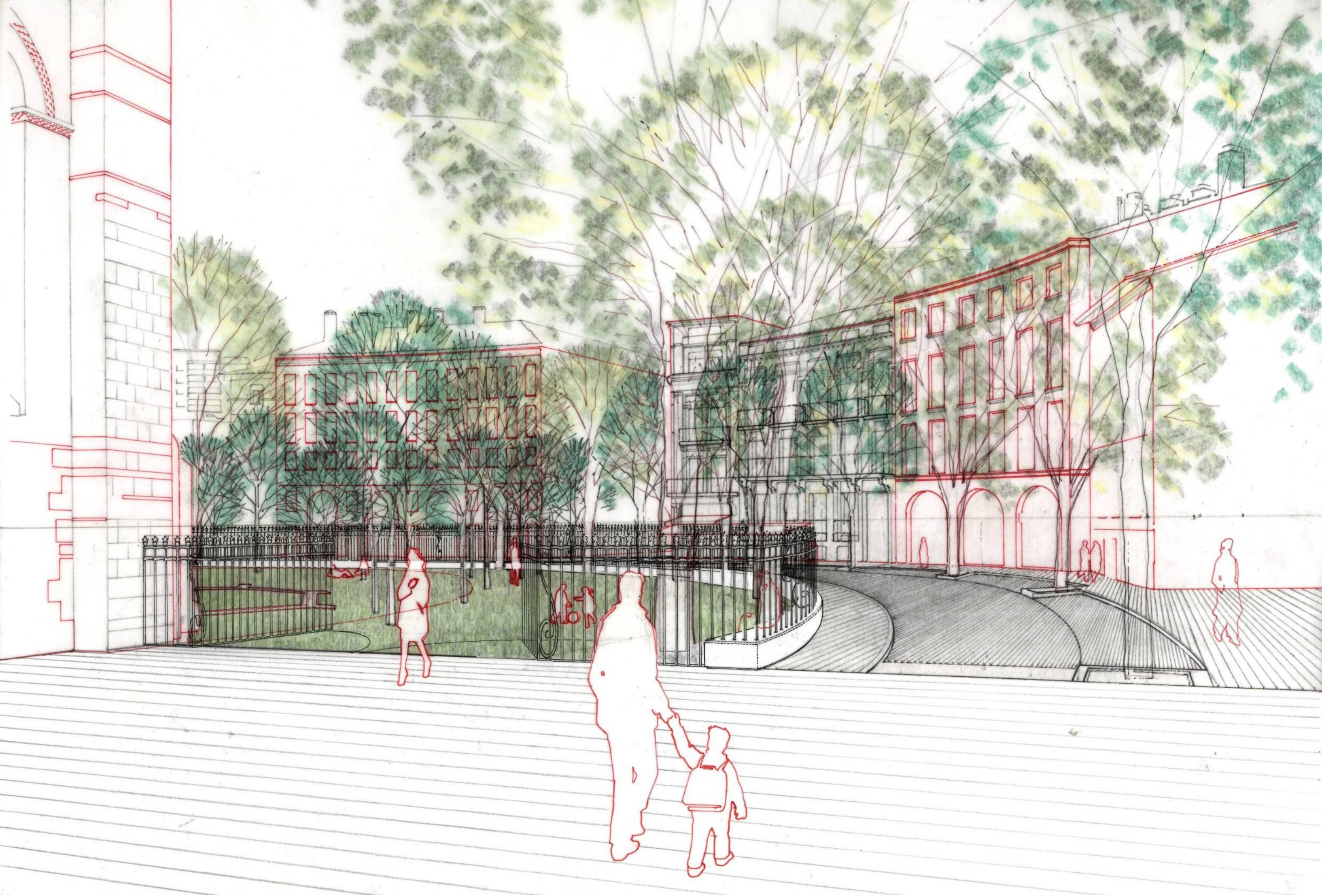



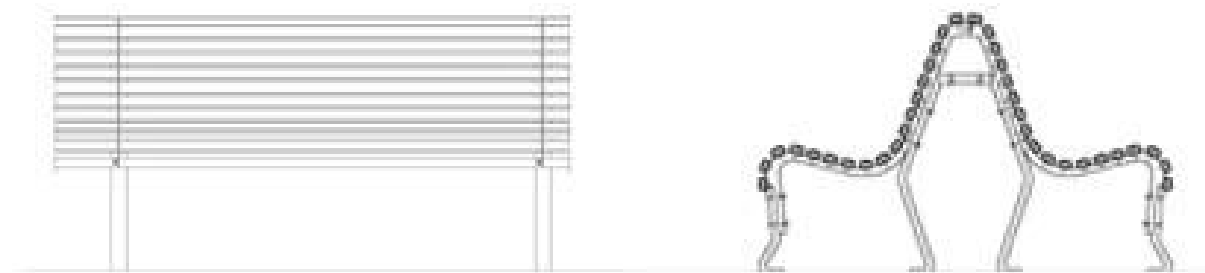







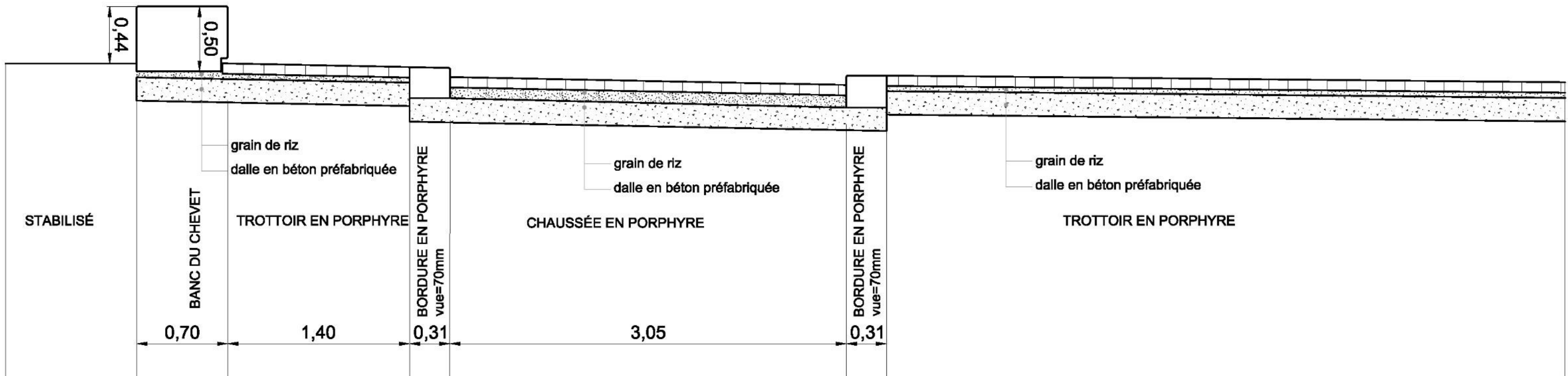
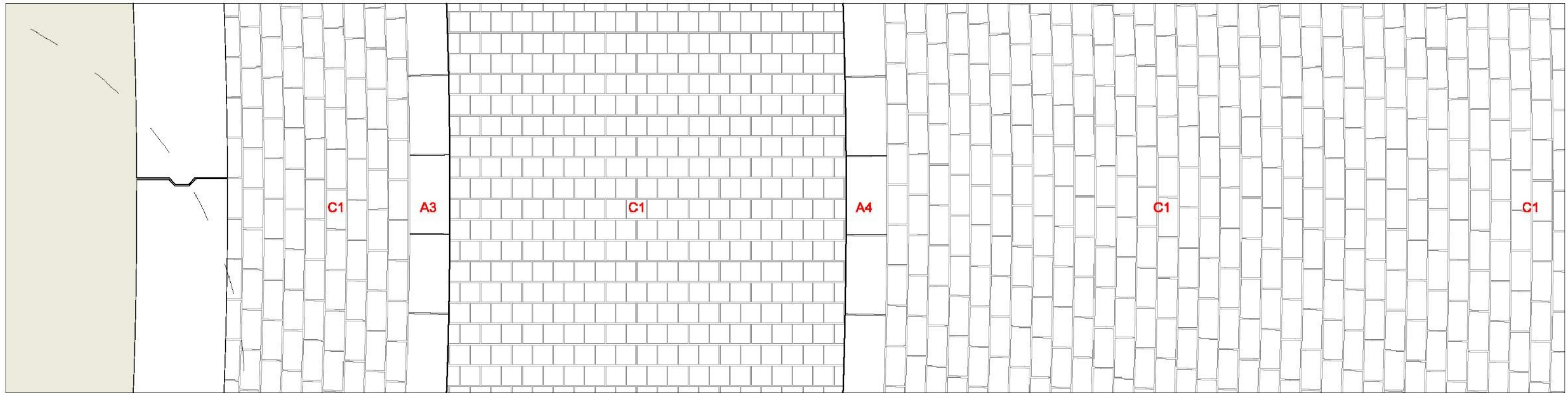

Joint = 10mm

Planche d'essai







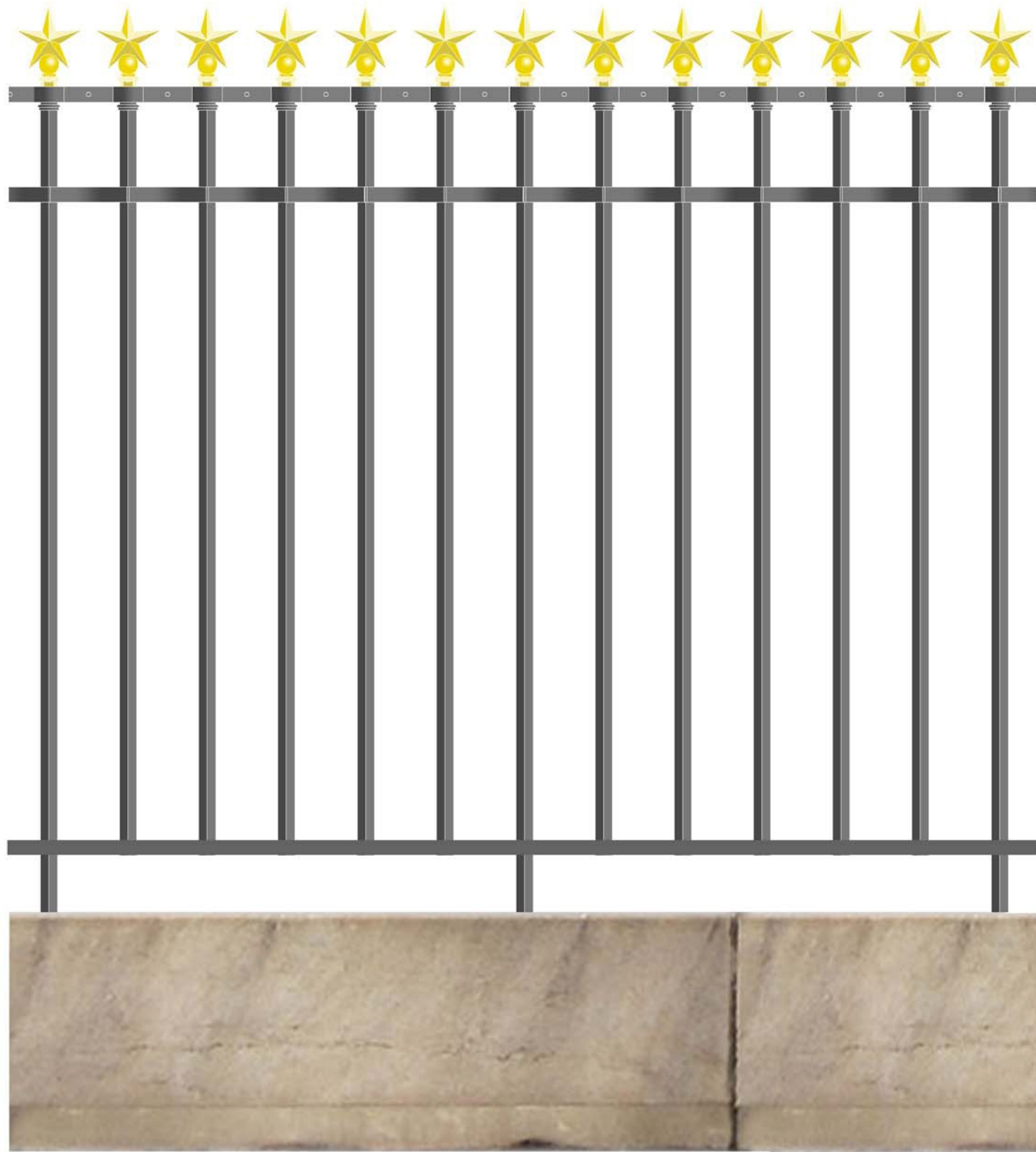

TOU-CV Saint-Sernin
BAU
1:10 (A3)

Grille existante déplacée sur banc





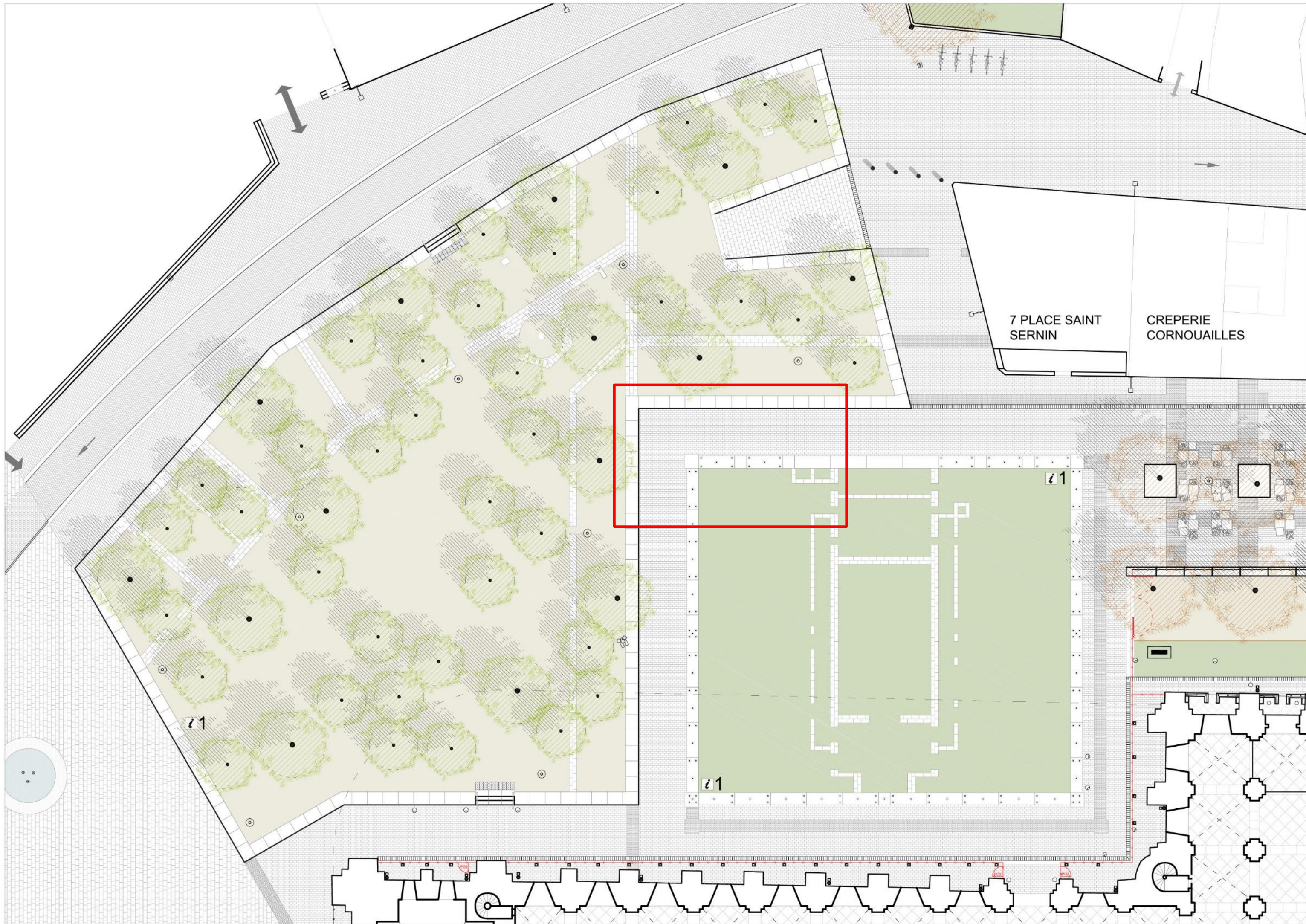



Planche d'essai





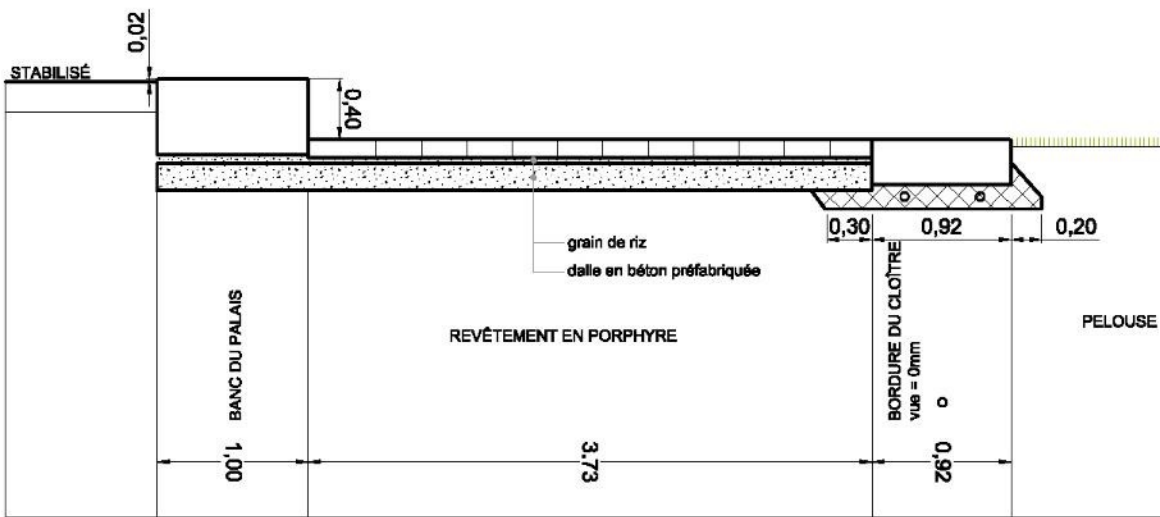